

BSN SERIES BARE SHAFT CENTRIFUGAL PUMPS

The Davies BSN series cast iron single impeller pumps are a DIN standard bare shaft pump designed for a wide range of applications where a separate power supply is beneficial. There is a range of models suitable for a wide variety of applications up to 4000 l/min and 60m head pressure with specific impeller trims available to select optimum performance. Bare shaft pumps may be pulley driven at speeds up to 3600 RPM.

Features

- Liquid temperature not higher than 35 °C for domestic use (CEI EN 60335-2-41) or 90 °C for other use, while the ambient temperature must not be higher than 40°C
- Flow rates up to 240 m³/h
- Heads up to 100 m



BSN SERIES

Technical Features

- Pump body: cast iron G20 with anti-corrosive coating.
- Motor bracket: cast iron G20 with anti-corrosive coating.
- Orifices in/outlet: DIN 2532 standards.
- Impeller: cast iron G20 with anti-corrosive coating.
- Threaded counter flanges: galvanized steel complete with EPDM gaskets.
- Pump shaft: stainless steel Aisi 304.
- Mechanical seal: carbon-ceramic.

***POA for Impeller trim for Type B or C**

| BSN SERIES BARE SHAFT CENTRIFUGAL PUMPS | | |
|---|------------|------|
| Model | Shaft Size | Trim |
| 220-BSN 40-125A | 24 | A |
| 220-BSN 40-200A | 24 | A |
| 220-BSN 50-125A | 24 | A |
| 220-BSN 50-250A | 24 | A |
| 220-BSN 65-125A | 24 | A |
| 220-BSN 65-200A | 24 | A |
| 220-BSN 80-160A | 24 | A |
| 220-BSN 80-250A | 32 | A |

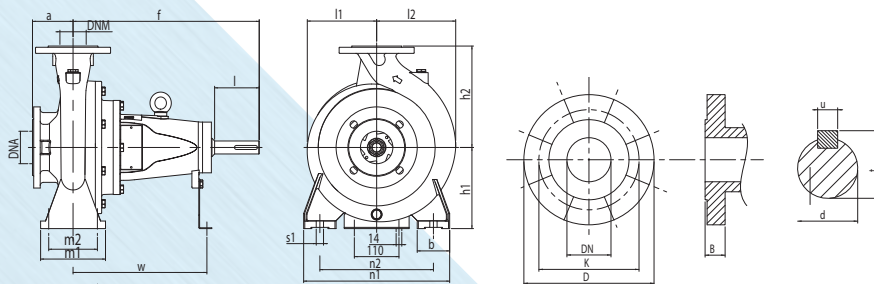

DIMENSIONS AND SPECIFICATIONS

| Model | DNA | DNM | a | f | h1 | h2 | l1 | l2 | m1 | m2 | n1 | n2 | b | s1 | w | d | i | u | t |
|-------------|-----|-----|-----|-----|-----|-----|-------|-------|-----|-----|-----|-----|----|----|-----|----|----|----|----|
| BSN 40-125A | 65 | 40 | 80 | 356 | 132 | 160 | 116.5 | 116.5 | 100 | 70 | 240 | 190 | 50 | 14 | 254 | 24 | 50 | 8 | 27 |
| BSN 40-200A | 65 | 40 | 100 | 356 | 160 | 180 | 140 | 140 | 100 | 70 | 265 | 212 | 50 | 14 | 254 | 24 | 50 | 8 | 27 |
| BSN 50-125A | 65 | 50 | 80 | 356 | 132 | 160 | 101.5 | 112 | 100 | 70 | 210 | 190 | 50 | 14 | 254 | 24 | 50 | 8 | 27 |
| BSN 50-250A | 65 | 50 | 100 | 360 | 180 | 225 | 166 | 170 | 125 | 95 | 320 | 250 | 65 | 14 | 254 | 24 | 50 | 8 | 27 |
| BSN 65-125A | 80 | 65 | 100 | 356 | 160 | 180 | 112 | 143 | 125 | 95 | 280 | 212 | 65 | 14 | 254 | 24 | 50 | 8 | 27 |
| BSN 65-200A | 80 | 65 | 100 | 365 | 180 | 225 | 147 | 168 | 125 | 95 | 320 | 250 | 65 | 14 | 258 | 24 | 50 | 8 | 27 |
| BSN 80-160A | 100 | 80 | 125 | 365 | 180 | 225 | 135 | 170 | 125 | 95 | 320 | 250 | 65 | 14 | 258 | 24 | 50 | 8 | 27 |
| BSN 80-250A | 100 | 80 | 125 | 470 | 200 | 280 | 195 | 218 | 160 | 120 | 400 | 315 | 80 | 18 | 340 | 32 | 80 | 10 | 35 |

| FLANGE- FLANGES | | | | HOLES MM | |
|-----------------|-----|-----|----|----------|----|
| DN | H | D | B | n° | σ |
| 32 | 100 | 140 | 18 | 4 | 18 |
| 40 | 110 | 150 | 18 | 4 | 18 |
| 50 | 125 | 165 | 19 | 4 | 18 |
| 65 | 145 | 185 | 19 | 4 | 18 |
| 80 | 160 | 200 | 22 | 4 | 18 |
| 100 | 180 | 220 | 24 | 8 | 18 |

QUICK SELECTION PERFORMANCE TABLE - 2900 RPM - 2 POLE

| Model | H _w | M ³ /H L/M | 0 | 6 | 12 | 18 | 24 | 30 | 36 | 42 | 48 | 60 | 66 | 78 | 96 | 132 | 156 | 180 | 240 | |
|-------------|----------------|--------------------------|-------|-------|-------|-------|-------|-------|-------|-------|-------|-------|-------|-------|-------|-------|-------|------|------|--|
| | | | 0 | 100 | 200 | 300 | 400 | 500 | 600 | 700 | 800 | 1000 | 1100 | 1300 | 1600 | 2200 | 2600 | 3000 | 4000 | |
| BSN 40-125C | 1.5 | H (m) | 17.5 | 18.0 | 18.3 | 17.5 | 16.0 | 13.5 | 11.0 | 9.0 | | | | | | | | | | |
| BSN 40-125B | 2.2 | | 22.0 | 22.5 | 22.5 | 22.0 | 20.5 | 18.5 | 16.5 | 12.5 | | | | | | | | | | |
| BSN 40-125A | 3.0 | | 26.5 | 27.5 | 27.5 | 26.5 | 25.5 | 23.7 | 21.5 | 17.5 | | | | | | | | | | |
| BSN 40-200B | 5.5 | | 44.0 | 44.8 | 44.5 | 43.5 | 42.0 | 39.0 | 34.5 | 29.0 | 24.5 | | | | | | | | | |
| BSN 40-200A | 7.5 | | 54.5 | 55.0 | 55.0 | 54.8 | 53.8 | 51.5 | 48.0 | 43.0 | 36.5 | | | | | | | | | |
| BSN 50-125C | 2.2 | | 17.5 | 18.0 | 18.0 | 18.0 | 17.5 | 16.5 | 15.5 | 14.0 | 12.5 | | | | | | | | | |
| BSN 50-125B | 3.0 | | 22.5 | 22.5 | 22.5 | 22.0 | 21.5 | 20.5 | 19.5 | 18.5 | 17.0 | | | | | | | | | |
| BSN 50-125A | 4.0 | | 25.5 | 26.0 | 26.0 | 25.5 | 25.3 | 54.8 | 24.0 | 23.0 | 22.0 | | | | | | | | | |
| BSN 50-250C | 15.0 | | 73.0 | 74.0 | 75.0 | 75.0 | 75.0 | 74.5 | 72.5 | 71.5 | 70.0 | 65.0 | 62.0 | 54.0 | | | | | | |
| BSN 50-250B | 18.5 | | 82.0 | 82.5 | 82.5 | 82.5 | 82.5 | 82.0 | 81.0 | 79.5 | 78.0 | 72.5 | 70.0 | 61.5 | | | | | | |
| BSN 50-250A | 22.0 | | 89.5 | 90.5 | 91.0 | 91.0 | 90.5 | 90.0 | 89.0 | 88.0 | 86.5 | 80.5 | 78.0 | 69.5 | | | | | | |
| BSN 65-125B | 5.5 | | 23.5 | 24.0 | 24.5 | 24.8 | 25.0 | 25.0 | 25.0 | 24.5 | 24.0 | 23.0 | 22.5 | 20.5 | 16.0 | | | | | |
| BSN 65-125A | 7.5 | | 26.0 | 26.3 | 26.5 | 26.8 | 27.0 | 27.0 | 26.8 | 26.6 | 26.4 | 26.0 | 24.5 | 23.0 | 18.5 | | | | | |
| BSN 65-200C | 15.0 | | 44.5 | 45.0 | 45.5 | 46.0 | 46.5 | 46.5 | 46.5 | 46.5 | 46.5 | 46.0 | 45.8 | 45.0 | 42.5 | 34.5 | | | | |
| BSN 65-200B | 18.5 | | 48.0 | 48.7 | 49.5 | 49.8 | 50.0 | 50.2 | 50.5 | 50.5 | 50.5 | 50.0 | 49.8 | 49.0 | 47.0 | 39.0 | | | | |
| BSN 65-200A | 22.0 | | 52.5 | 53.0 | 53.5 | 53.8 | 54.0 | 54.5 | 54.7 | 54.8 | 54.8 | 54.5 | 54.0 | 53.5 | 52.0 | 44.5 | | | | |
| BSN 80-160D | 11.0 | | 27.0 | 27.7 | 28.3 | 28.6 | 28.8 | 29.0 | 29.5 | 29.7 | 29.8 | 29.8 | 29.8 | 29.2 | 28.5 | 25.0 | 22.0 | | | |
| BSN 80-160C | 15.0 | | 32.0 | 32.5 | 33.0 | 33.3 | 33.5 | 34.0 | 34.5 | 34.7 | 34.5 | 34.5 | 34.5 | 34.2 | 33.5 | 30.5 | 27.5 | | | |
| BSN 80-160B | 18.5 | | 35.0 | 35.5 | 36.0 | 36.3 | 36.5 | 37.0 | 37.5 | 37.5 | 37.5 | 37.5 | 37.5 | 37.5 | 37.0 | 34.5 | 32.0 | | | |
| BSN 80-160A | 22.0 | | 39.0 | 39.3 | 39.5 | 39.8 | 40.0 | 40.5 | 41.0 | 41.0 | 41.0 | 41.5 | 41.5 | 41.2 | 40.5 | 38.0 | 36.5 | | | |
| BSN 80-250C | 45.0 | 67.5 | 68.0 | 68.5 | 68.8 | 69.0 | 69.5 | 70.0 | 70.0 | 70.0 | 70.0 | 70.0 | 70.0 | 70.0 | 68.5 | 66.0 | 63.0 | 50.0 | | |
| BSN 80-250B | 55.0 | 82.0 | 82.7 | 83.5 | 83.8 | 85.0 | 86.0 | 86.5 | 87.0 | 87.0 | 88.0 | 88.0 | 88.0 | 87.5 | 86.0 | 83.5 | 81.0 | 70.0 | | |
| BSN 80-250A | 75.0 | 101.5 | 101.7 | 101.8 | 101.9 | 102.0 | 102.5 | 103.0 | 103.0 | 103.0 | 103.5 | 103.5 | 104.0 | 104.0 | 103.5 | 102.5 | 101.5 | 92.0 | | |

QUICK SELECTION PERFORMANCE TABLE - 1450 RPM - 4 POLE

| Model | Hw | M ³ /H L/M | 0 | 3 | 6 | 9 | 12 | 15 | 18 | 21 | 24 | 30 | 36 | 42 | 51 | 66 | 78 | 90 | 120 | |
|-------------|------|--------------------------|------|------|------|------|------|------|------|------|------|------|------|------|------|------|------|------|------|--|
| | | | 0 | 50 | 100 | 150 | 200 | 250 | 300 | 350 | 400 | 500 | 600 | 700 | 850 | 1100 | 1300 | 1500 | 2000 | |
| BSN 40-125C | 0.25 | H (m) | 4.4 | 4.5 | 4.6 | 4.4 | 4.0 | 3.4 | 2.8 | | | | | | | | | | | |
| BSN 40-125B | 0.25 | | 5.5 | 5.6 | 5.6 | 5.5 | 5.1 | 4.6 | 4.1 | 3.1 | | | | | | | | | | |
| BSN 40-125A | 0.37 | | 6.6 | 6.9 | 6.9 | 6.6 | 6.4 | 5.9 | 5.4 | 4.4 | | | | | | | | | | |
| BSN 40-200B | 0.75 | | 11 | 11.2 | 11.1 | 10.9 | 10.5 | 9.8 | 8.6 | 7.3 | | | | | | | | | | |
| BSN 40-200A | 1.1 | | 13.6 | 13.8 | 13.8 | 13.7 | 13.5 | 12.9 | 12.0 | 10.8 | 9.1 | | | | | | | | | |
| BSN 50-125C | 0.37 | | 4.4 | 4.5 | 4.5 | 4.5 | 4.4 | 4.1 | 3.9 | 3.5 | 3.1 | | | | | | | | | |
| BSN 50-125B | 0.37 | | 5.6 | 5.6 | 5.6 | 5.5 | 5.4 | 5.1 | 4.9 | 4.6 | 4.3 | | | | | | | | | |
| BSN 50-125A | 0.55 | | 6.4 | 6.5 | 6.5 | 6.4 | 6.3 | 13.7 | 6.0 | 5.8 | 5.5 | | | | | | | | | |
| BSN 50-250C | 2.2 | | 18.3 | 18.5 | 18.8 | 18.8 | 18.8 | 18.6 | 18.1 | 17.9 | 17.5 | 16.3 | 14.5 | | | | | | | |
| BSN 50-250B | 3.0 | | 20.5 | 20.6 | 20.6 | 20.6 | 20.6 | 20.5 | 20.3 | 19.9 | 19.5 | 18.1 | 16.6 | | | | | | | |
| BSN 50-250A | 3.0 | | 22.4 | 22.6 | 22.8 | 22.8 | 22.6 | 22.5 | 22.3 | 22.0 | 21.6 | 20.1 | 18.5 | | | | | | | |
| BSN 65-125B | 0.75 | | 5.9 | 6.0 | 6.1 | 6.2 | 6.3 | 6.3 | 6.3 | 6.1 | 6.0 | 5.8 | 5.4 | 4.8 | 3.5 | | | | | |
| BSN 65-125A | 1.1 | | 6.5 | 6.5 | 6.6 | 6.7 | 6.8 | 6.8 | 6.7 | 6.7 | 6.6 | 6.5 | 5.9 | 5.4 | 4.3 | | | | | |
| BSN 65-200C | 2.2 | | 11.1 | 11.3 | 11.4 | 11.5 | 11.6 | 11.6 | 11.6 | 11.6 | 11.6 | 11.5 | 11.4 | 11.1 | 10.4 | 8.6 | | | | |
| BSN 65-200B | 2.2 | | 12.0 | 12.2 | 12.4 | 12.5 | 12.5 | 12.6 | 12.6 | 12.6 | 12.6 | 12.5 | 12.4 | 12.1 | 11.5 | 9.8 | | | | |
| BSN 65-200A | 3.0 | | 13.1 | 13.3 | 13.4 | 13.5 | 13.5 | 13.6 | 13.7 | 13.7 | 13.7 | 13.6 | 13.4 | 13.3 | 12.8 | 11.1 | | | | |
| BSN 80-160D | 1.5 | | 6.8 | 7.0 | 7.1 | 7.2 | 7.2 | 7.3 | 7.4 | 7.4 | 7.5 | 7.5 | 7.4 | 7.3 | 7.0 | 6.3 | 5.5 | | | |
| BSN 80-160C | 2.2 | | 8.0 | 8.2 | 8.3 | 8.3 | 8.4 | 8.5 | 8.6 | 8.7 | 8.6 | 8.6 | 8.6 | 8.5 | 8.3 | 7.6 | 6.9 | | | |
| BSN 80-160B | 3.0 | | 8.8 | 8.9 | 9.0 | 9.1 | 9.1 | 9.3 | 9.4 | 9.4 | 9.4 | 9.4 | 9.4 | 9.3 | 9.1 | 8.6 | 8.0 | | | |
| BSN 80-160A | 4.0 | | 9.8 | 9.9 | 9.9 | 10.0 | 10.0 | 10.1 | 10.3 | 10.3 | 10.3 | 10.4 | 10.4 | 10.3 | 10.0 | 9.5 | 9.1 | | | |
| BSN 80-250C | 4.0 | 16.9 | 17.0 | 17.1 | 17.2 | 17.3 | 17.4 | 17.5 | 17.5 | 17.5 | 17.5 | 17.5 | 17.5 | 17.5 | 17.1 | 16.5 | 16.8 | 12.5 | | |
| BSN 80-250B | 5.5 | 20.5 | 20.7 | 20.9 | 21.1 | 21.3 | 21.5 | 21.6 | 21.8 | 21.8 | 22.0 | 22.0 | 22.0 | 21.9 | 21.5 | 20.9 | 20.3 | 17.5 | | |
| BSN 80-250A | 7.5 | 25.4 | 25.5 | 25.5 | 25.5 | 25.5 | 25.6 | 25.8 | 25.8 | 25.8 | 25.9 | 26.0 | 26.0 | 26.1 | 25.9 | 25.6 | 25.4 | 23.0 | | |

For your nearest dealer please contact Argon Distributors: 0508 634 341

While every effort has been taken to publish correct details in this guide, due to a process of continuous development, no responsibility will be taken for errors, omissions or changes in product specifications. Images are representations only and may differ from actual product. Davies Pumps and the 'dp' logo are registered trademarks of Argon Distributors.